

# Map With Attributes

Parcel Report for APN :	<b>127-43-030</b>
Net Lot Size:	<b>11,138 sf</b>
Zone Dist:	<b>R-1 (8000)</b>
Comp Plan Des:	<b>SF</b>
Flood Zone:	<b>AE10.5</b>
FEMA Map Panel:	<b>0036H</b>
Parking District:	<b>none</b>
SCCA* YR Built:	<b>1953</b>
Historic Status:	<b>none</b>
LOMA:	<b>no</b>
HMP Request:	<b>no</b>
SCCA* Eff. YR Built:	<b>1963</b>
Traffic Imp. Dist:	<b>none</b>
Easements:	<b>no</b>
Near Creek:	<b>no</b>
Flag Lot:	<b>no</b>
Substandard:	<b>no</b>
Annual Office and R&D Cap Monitoring:	<b>no</b>
Housing Incentive Program:	<b>no</b>
ADU/JADU:	<b>See Muni Code 18.09</b>
	<a href="https://codelibrary.amlegal.com/codes/paloalto/latest/paloalto_ca/0-0-0-76738">https://codelibrary.amlegal.com/codes/paloalto/latest/paloalto_ca/0-0-0-76738</a>
FAR:	<b>4,092 sf</b>
Max Building Height:	<b>If roof slope &lt; 12:12, 30'</b> <b>If roof slope &gt;= 12:12, 33'</b>
Max Lot Coverage:	<b>If single story, 4,092 sf</b> <b>If two story, 3,898 sf</b>
Special Setbacks:	<b>none</b> <b>If no special setback, 20', or,</b> <b>if avg. contextual setback &gt; 30',</b> <b>the avg. contextual setback.</b>
Minimum Setbacks:	<b>Front:</b> <b>Rear:</b> 20' <b>Interior Side(s):</b> 8' <b>Street Side:</b> <b>If no special setback, 16'</b>
Comments:	<b>none</b>
* Source of year built data is the Santa Clara County Assessor Click below link for data details or navigate to <a href="https://www.cityofpaloalto.org/gov/depts/pln/current/parcel_reports.asp">https://www.cityofpaloalto.org/gov/depts/pln/current/parcel_reports.asp</a>	

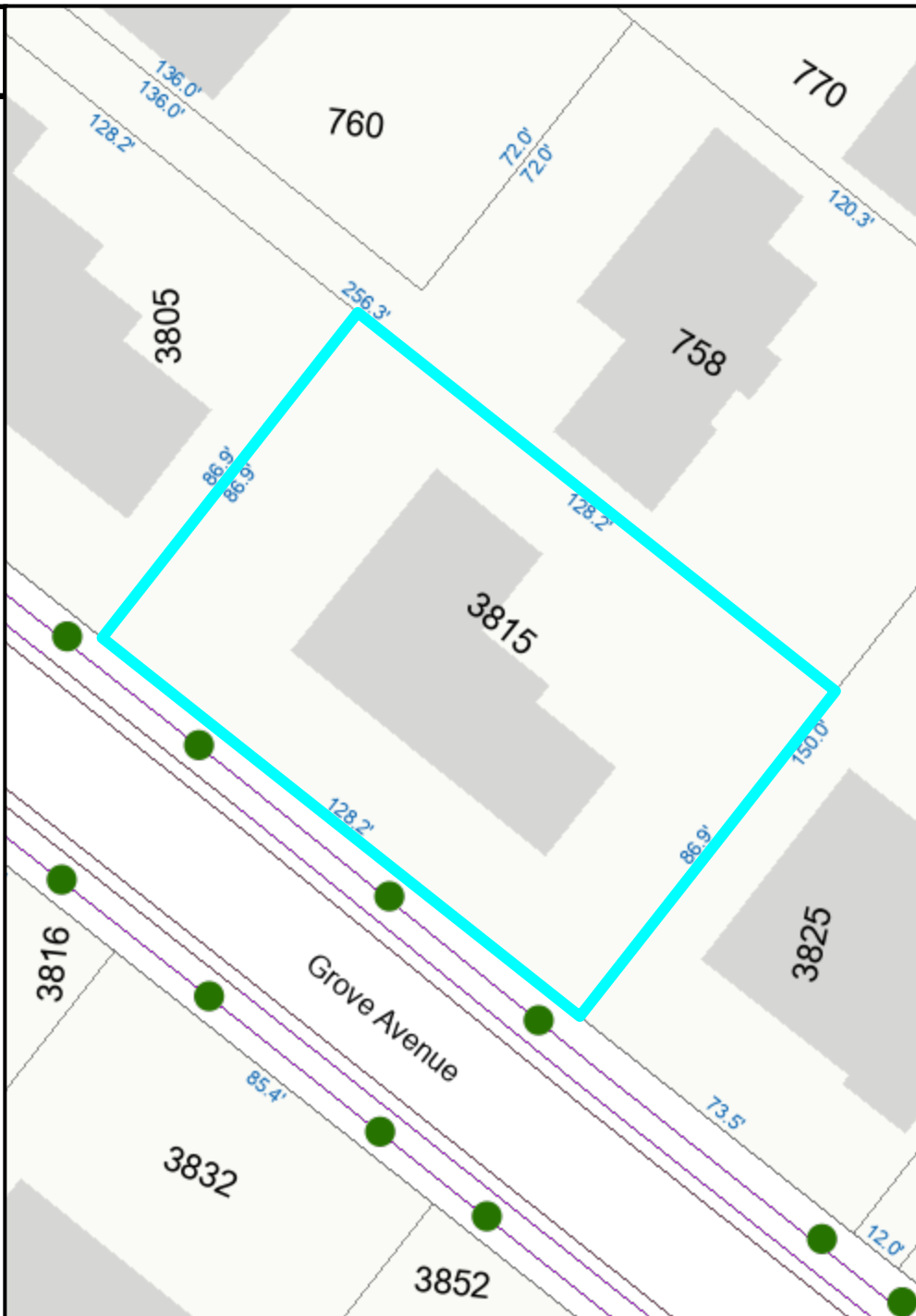



The City of  
**Palo Alto**



3815 Grove Av

This map is a product  
of the  
City of Palo Alto GIS